

Spacecraft Assembly - Pre-Analysis & Start-Up

Authors: Rajesh Bhaskaran & Michael Mahoney, Cornell University

[Problem Specification](#)

[1. Pre-Analysis & Start-Up](#)

[2. Geometry](#)

[3. Mesh](#)

[4. Physics Setup](#)

[5. Numerical Solution](#)

[6. Numerical Results](#)

[7. Verification & Validation](#)

[Exercises](#)

[Comments](#)

Pre-Analysis & Start-Up

In the *Pre-Analysis* step, we'll first consider how to reduce the model using periodicity. Then, we'll review the following:

- **Mathematical model**
- **Numerical solution strategy**
- **Hand-calculations of expected results**

Model Reduction

We'll model half-a-bolt assuming periodic symmetry. The reduced model has four parts which are indicated in different colors in the image below.

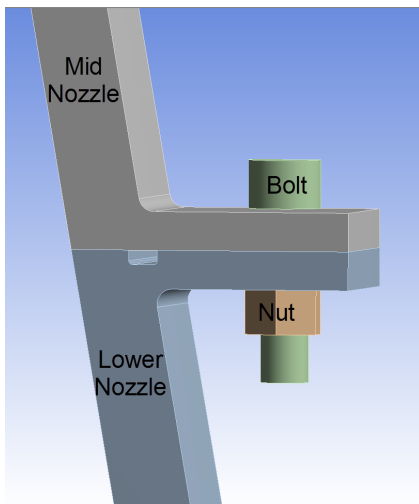

Mathematical Model



Under Construction

Numerical Solution Procedure in ANSYS



Under Construction

Hand-Calculations of Expected Results



Under Construction

[Go to Step 2: Geometry](#)

[Go to all ANSYS Learning Modules](#)