

# Olin Library -- 501 Suite Program

## General Principles

- **Ambiance:** environment and services conducive to spending long hours of deep research and reading
- **Target Group:** graduate students in the humanities and social sciences, especially graduate students using collections in the current Olin graduate reading rooms
- **Seating:** 60-70
- **Collections:** maximize collections space using shelving to define seating areas as well as accommodate discipline specific material
- **Design considerations:** acoustics, lighting, and flexibility

## 501A

- **Ambiance/room type:** informal reading room
- **Seating:** soft seating w/moveable wood tables for 1 to 2 people
- **Special fixtures:** none

## 501B

- **Ambiance/room type:** flexible reading room/meeting room w/patron sign-up
- **Seating:** 2 wood moveable tables; space for 8 people
- **Special fixtures/features:** 2 white boards for walls

## 501

- **Ambiance/room type:** more formal reading room similar to A.D. White in Uris; comfortable space for extended hours
- **Seating:** no carrels; some soft seating; predominantly tables for 2 people (1 on each side) not arranged in a linear fashion; availability of larger tables for spreading out material
- **Special fixtures/features:** 2-sit down and 2-stand up computers; wood lockers that could accommodate a coat, bag, and laptop

## 501C, 501D, 501E

- **Ambiance/room type:** 2 rooms for discussion w/patron sign-up; 1 room for printing
- **Seating:** discussion rooms for 2 to 4 people
- **Special fixtures/features:** Printer room w/MFP (multi-functional printer)

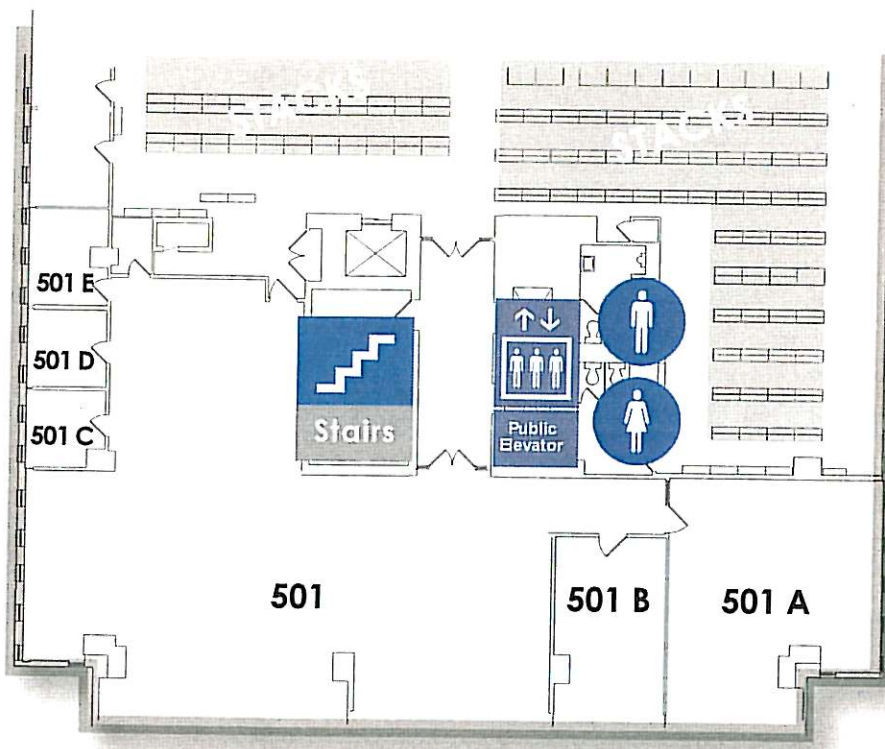

## Constraints

- **Design:** ceiling height, existing space elements (walls, exposed sprinkler pipes)
- **Budget:** refurbishment, not a renovation



North View  
5<sup>th</sup> Floor Reading Room  
Renovations to Olin Library  
Oct. 11, 2011



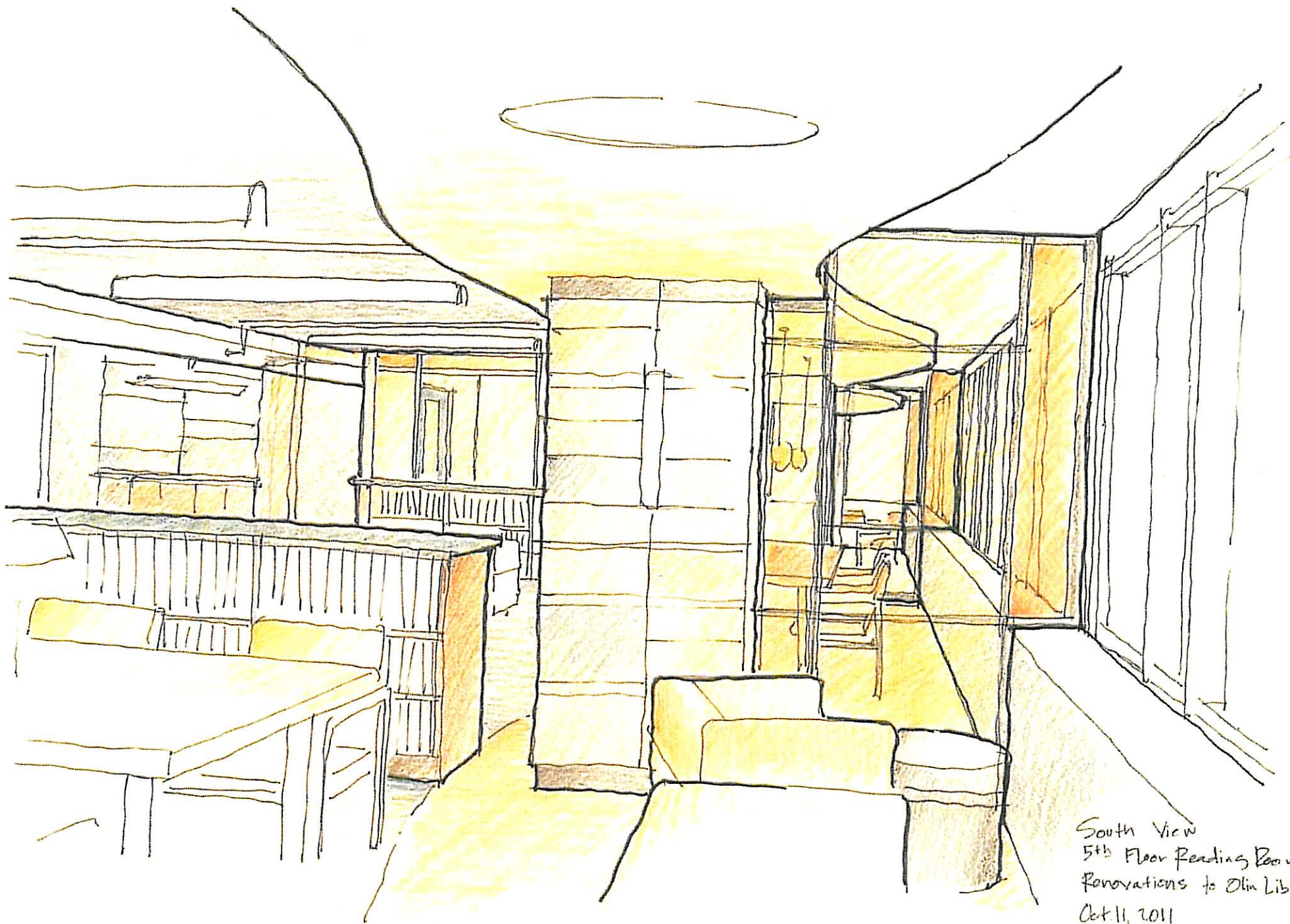

South View  
5th Floor Reading Room  
Renovations to Olin Library  
Oct 11, 2011